

Onebill. CloudVoice

# How to set up your SoGEA router

## How to set up your SoGEA router

- First, check the contents in your box.

Ensure that your router package includes all necessary components;

- The router
- User guides
- Micro filter
- DSL cable (grey)
- Ethernet cable
- Power adaptor (black).



Router

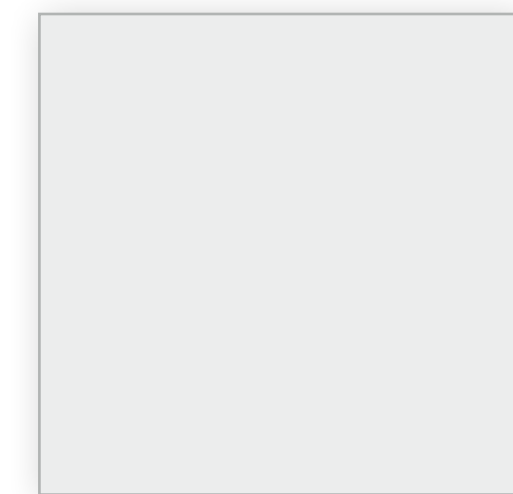

Quick start leaflet

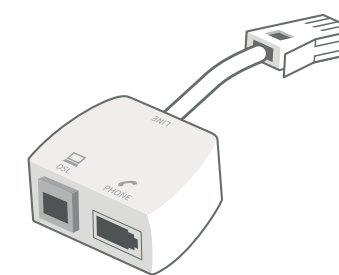

Micro filter

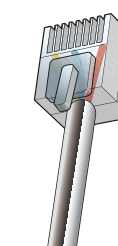

DSL Cable

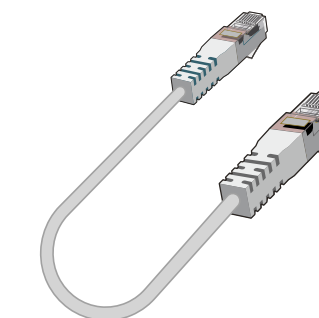

Ethernet cable

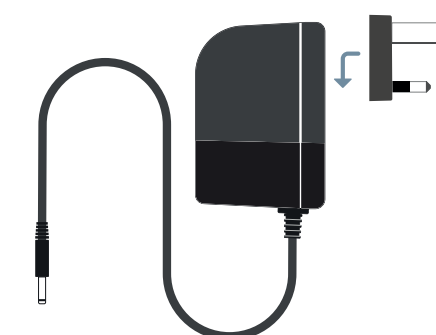

Power adaptor

## How to set up your SoGEA router

- Once your SoGEA has been installed/activated, you will receive confirmation by email or SMS.

If it's not active, contact **Onebill** on **0808 178 5200** for activation.

---

## How to set up your SoGEA router

### Router setup steps

You can now proceed to set up your hardware.

1. Plug in the router to a power source using the provided power adaptor.

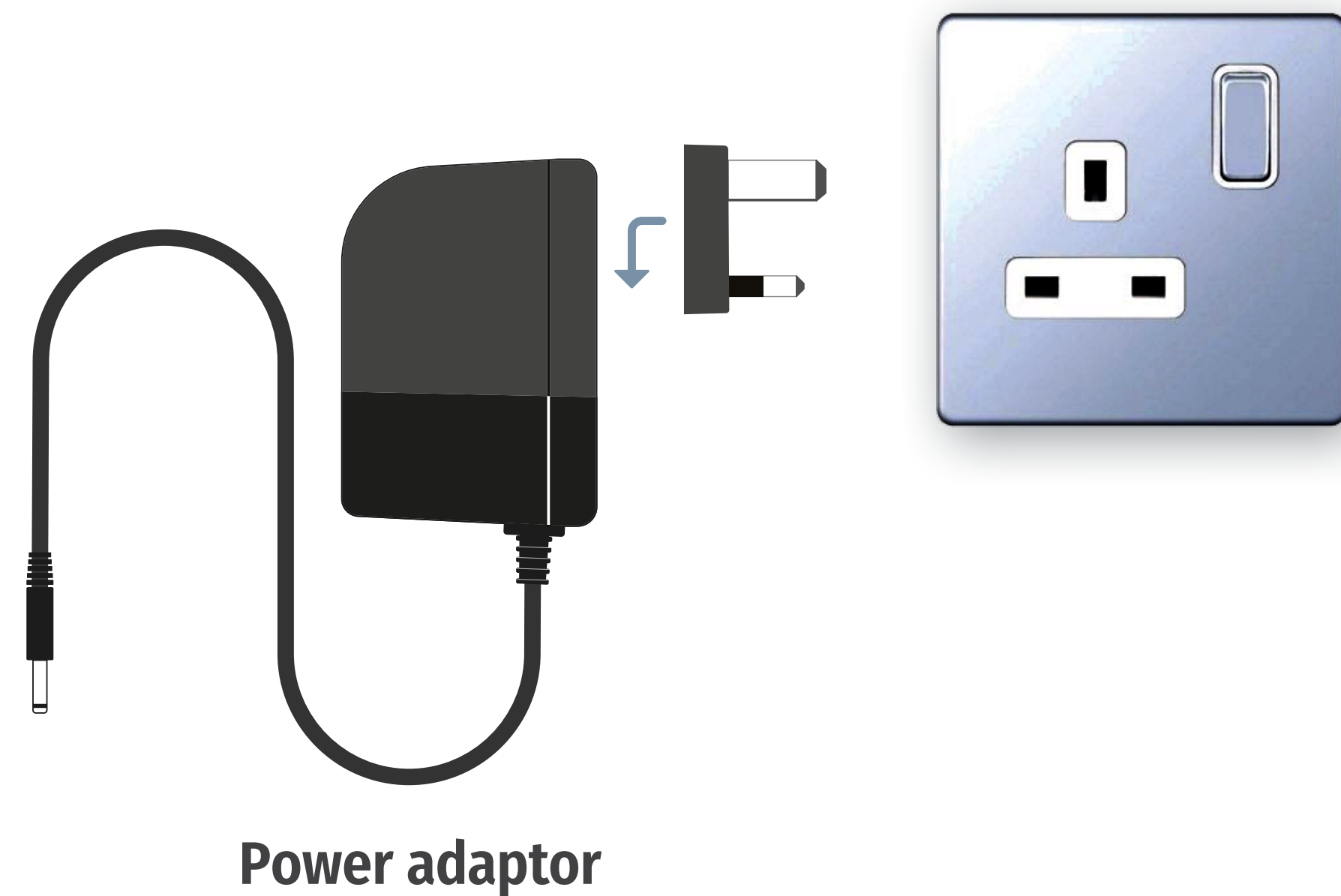

## How to set up your SoGEA router

### Router setup steps

2. Locate the Openreach master socket (this may vary depending on the type of master socket).
- 2a. If the master socket has two connection ports, this is likely to be a pre-filtered master socket.
- 2b. If the master socket has one connection port, this will require the micro-filter provided. Please plug this in now.

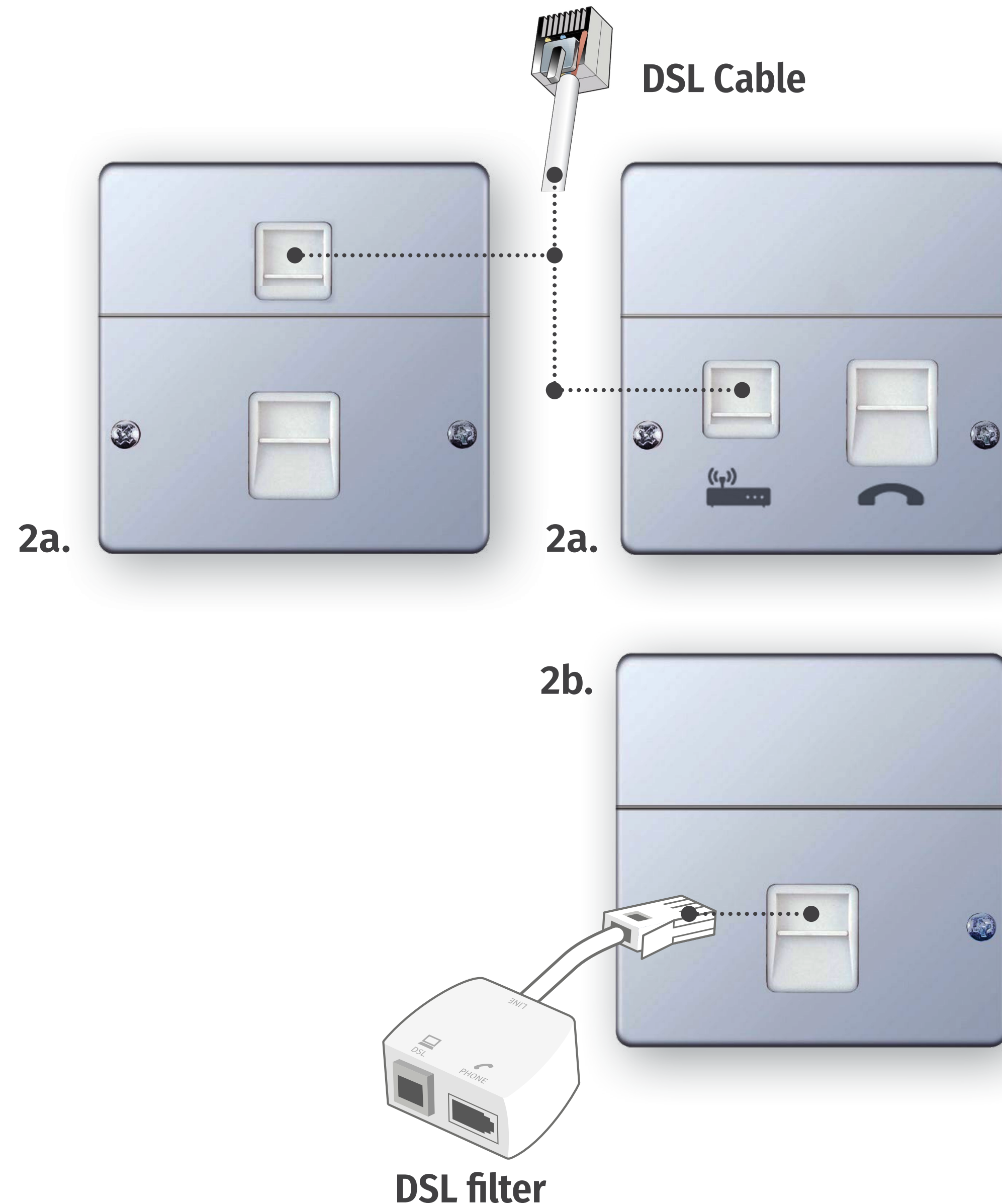



## How to set up your SoGEA router

**Router setup steps**

- 3a. If (A), plug the DSL cable directly into the master socket (DSL port).
- 3b. If (B) plug the DSL cable into the DSL port on the micro-filter.

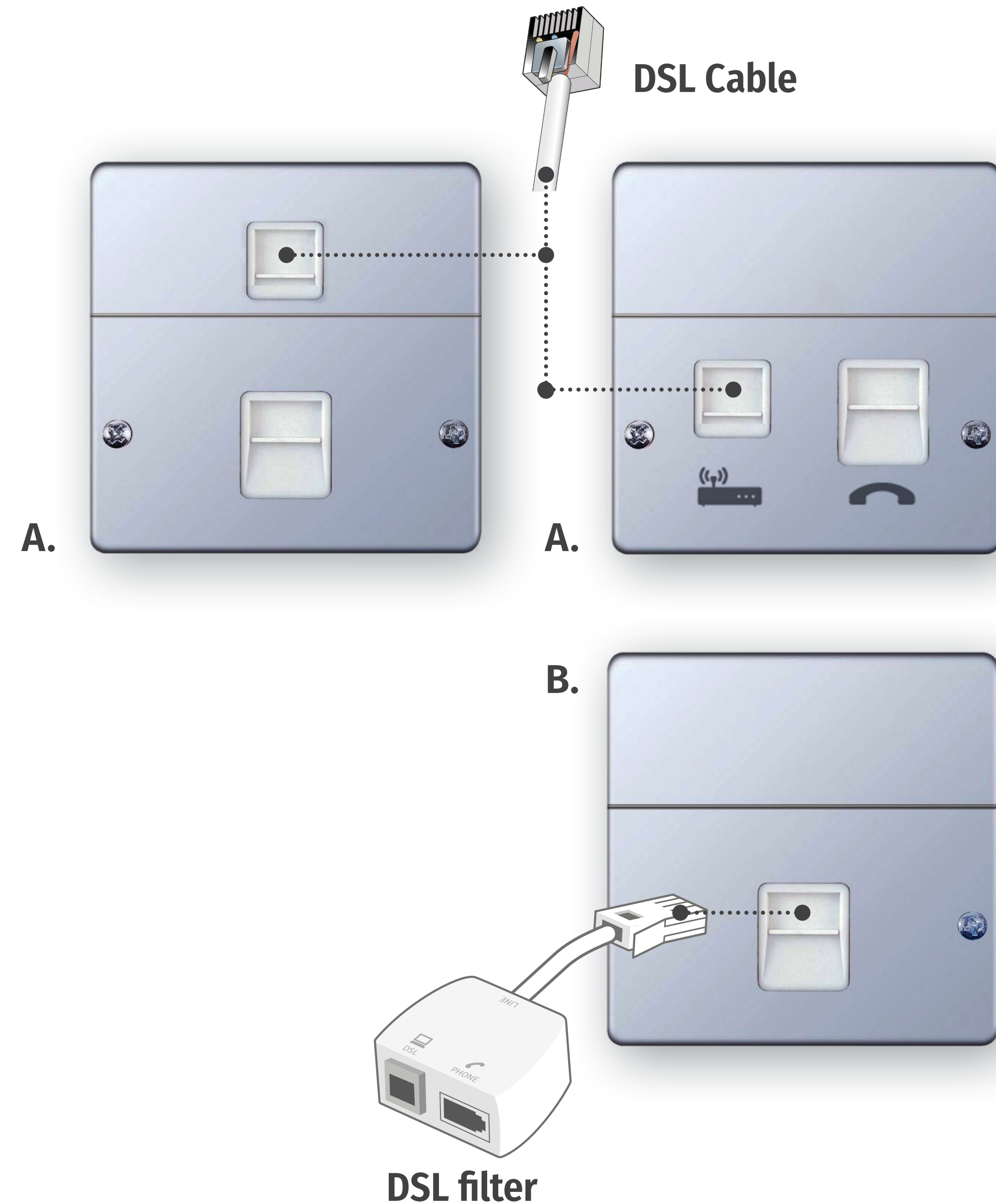

## How to set up your SoGEA router

### Router setup steps

4. The other end of the DSL cable goes directly into the grey DSL port located on the router.

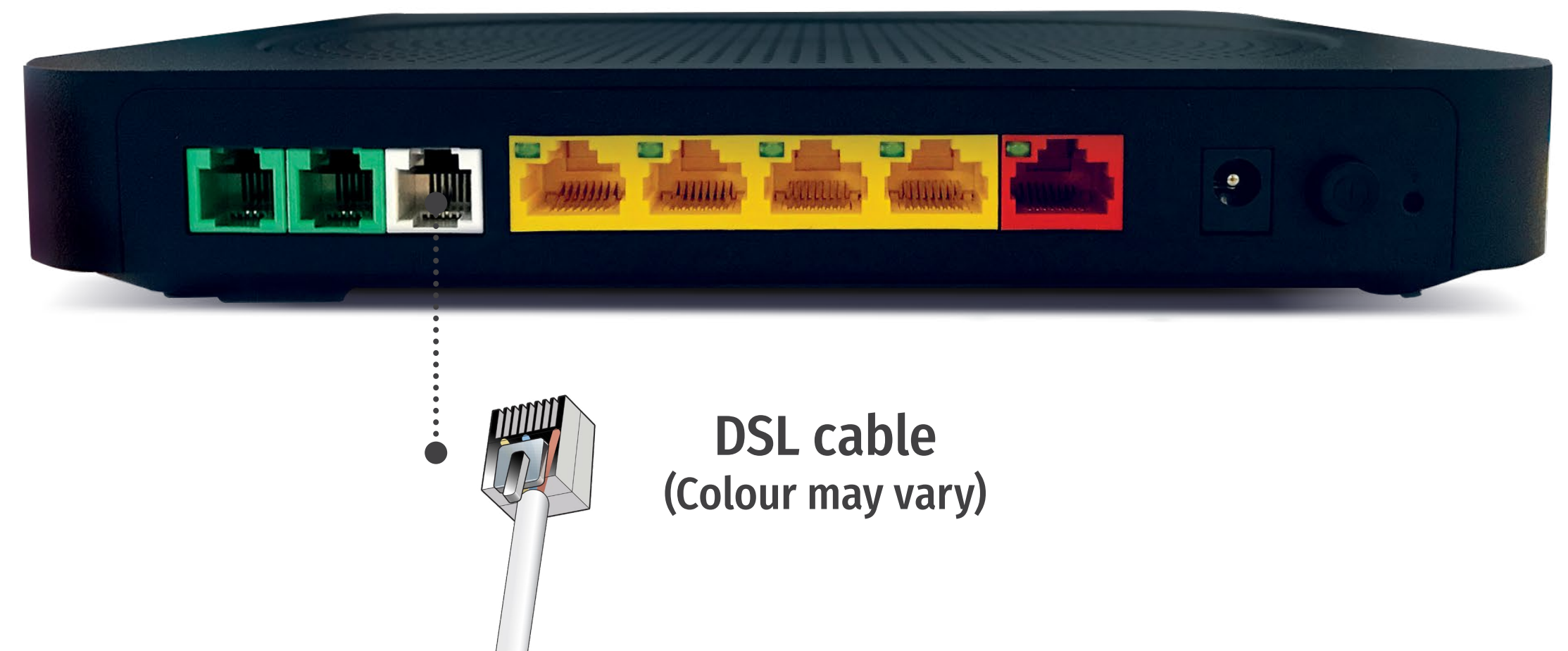



## How to set up your SoGEA router

### Router setup steps

5. Please wait three to five minutes.  
The router should now have three solid green lights.





## How to set up your SoGEA router

### Router setup steps

- The wireless lights will now be flashing green. You can now proceed to connect your devices.





## How to set up your SoGEA router

### Router setup steps

#### If the router lights are not flashing:

- On the front of the router, turn the wireless button on/off (reset button).

Alternatively, remove the power from the router for 1 minute and then plug it back in.

If neither solutions work, please call our technical support team on **0808 178 5200**.

IMPORTANT!



• Reset button

Onebill.

Making.business.**simple.**